

Model: Bellini		Date: 26-May-00	No.: RA294013
Subject: Decal - Paper Set Direction		Prepared by: H.K.	
From: Technical Services Dept., GTS Division			
Classification:	<input type="checkbox"/> Troubleshooting	<input type="checkbox"/> Part information	<input checked="" type="checkbox"/> Action required
	<input type="checkbox"/> Mechanical	<input type="checkbox"/> Electrical	<input type="checkbox"/> Service manual revision
	<input type="checkbox"/> Paper path	<input type="checkbox"/> Transmit/receive	<input type="checkbox"/> Retrofit information
	<input type="checkbox"/> Other ()		

The following decal has been added to the accessories for the mainframe copier and LCT from May production.

	New part number	Description	Q'ty	Int	Page	Index	Note
	A2941307	Decal - Paper Set Direction	3		181	*43	A294 copier
	A2941307	Decal - Paper Set Direction	3		37	*18	B303 LCT

*:New index

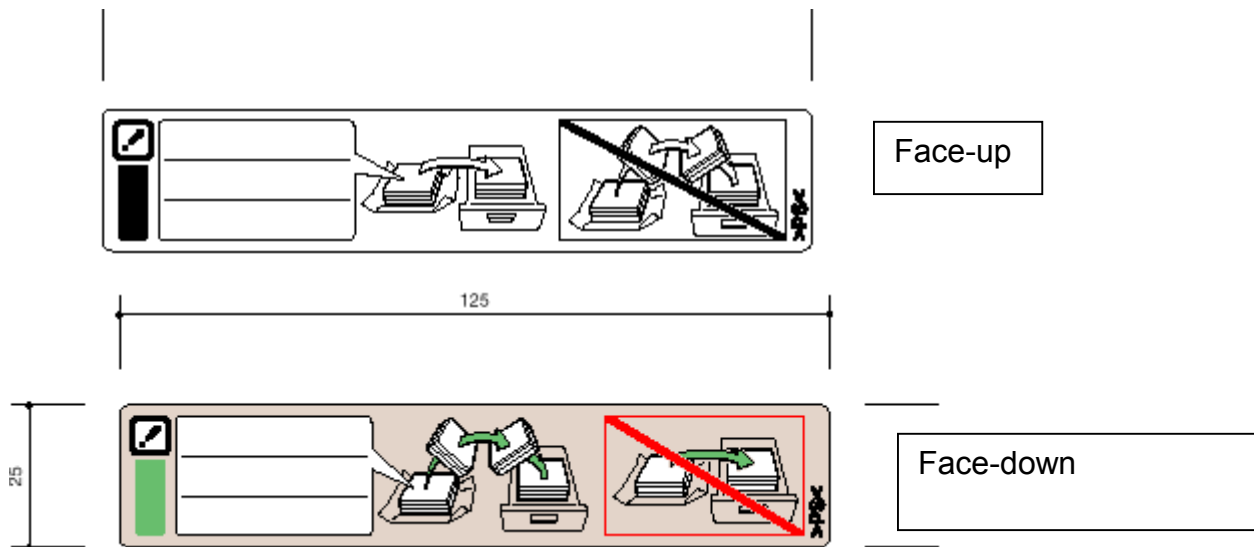

Decal - Paper Set Direction

The finisher stacking ability depends on the paper load orientation (face-up or face-down). For some paper brands, face-up produces better stacking and for other brands, face down is better. The above decal instructs customers on loading paper in order to prevent unnecessary service calls. Therefore, please use this decal for operator training.

Model: Bellini		Date: 03-Aug-00	No.: RA294028
Subject: Paper Guide Fence		Prepared by: H.K.	
From: Technical Services Dept., GTS Division			
Classification:	<input type="checkbox"/> Troubleshooting	<input checked="" type="checkbox"/> Part information	<input type="checkbox"/> Action required
	<input type="checkbox"/> Mechanical	<input type="checkbox"/> Electrical	<input type="checkbox"/> Service manual revision
	<input type="checkbox"/> Paper path	<input type="checkbox"/> Transmit/receive	<input type="checkbox"/> Retrofit information
	<input type="checkbox"/> Other ()		

SYMPTOM

The end fence may detach due to vibration during transport.

CAUSE

The diameter of the holes in the paper guide fence for inserting the end fence was slightly too large (i.e. Knob Screw with Rubber Tube). This is a side effect from the previous modification (MB No.004).

SOLUTION

Final countermeasure on the production line

The diameter of the holes in the paper guide fence for inserting the end fence has been decreased from 5.5 mm to 4.5 mm. Please refer to MB No. 006.

Temporary countermeasure on the production line

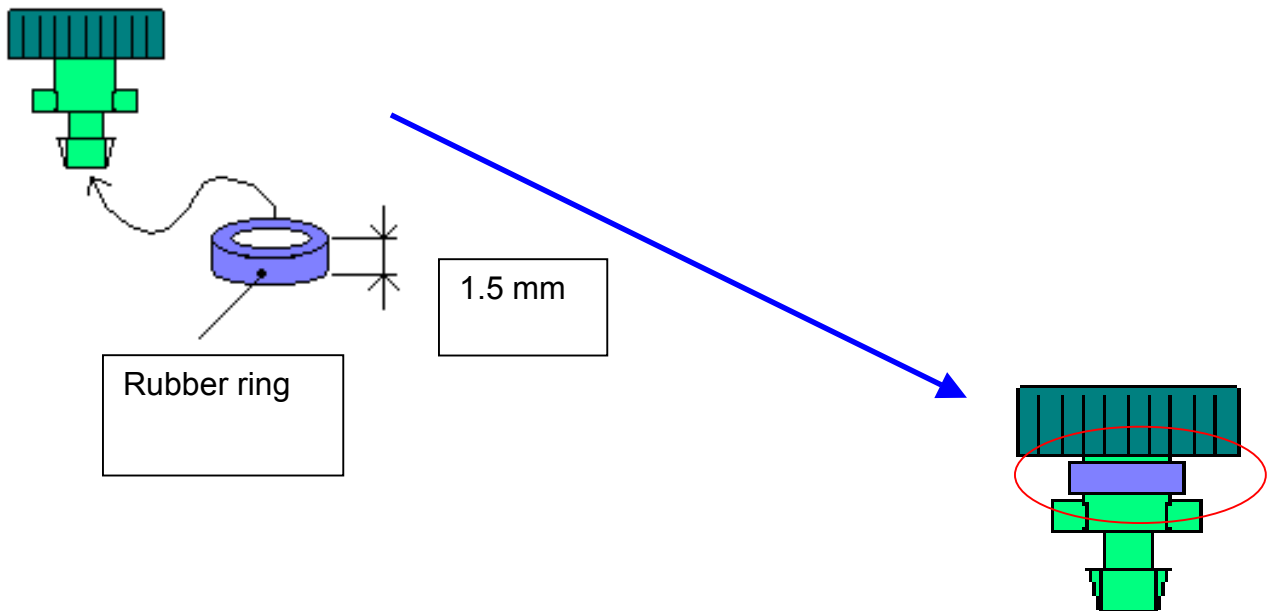

An extra rubber ring (1.5 mm) has been attached to the end fence to prevent it from dropping. This rubber ring is made by cutting the Rubber Tube (B3032788) in the production line to a thickness of 1.5 mm.

Model: Bellini

Date: 03-Aug-00

No.: RA294028

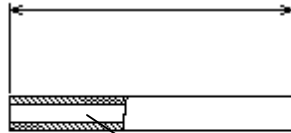

Rubber Tube - 2x4x33
B3032788

Note: When the new paper guide fence (B3032789: MB No.006) is installed in machines with the extra rubber ring, it is not necessary to remove the rubber ring from the end fence.

Note:

We have applied the temporary solution at the factory from the same cut-in serial numbers listed in MB No.004, except for the machines listed below. These units have already been shipped and do not contain the countermeasures. However we estimate the occurrence rate to be very low. Please reattach the end fence if it has come off during transport.

B30317 33 units:

H3900400592 to H3900400624

Model: Bellini

Date: 26-May-00

No.: RA294013

1. Using the mainframe paper trays, make more than 10 copies of a given paper brand face-up and face-down. Try to use paper which is normally used by the customers.
2. Compare the curl of the two bunches of paper by placing them on a flat surface.
3. If the face-down bunch shows less curling, write in the brand name on the face-down label (and vice-versa).
4. Repeat steps 1 to 3 for all the brands of paper normally used by the customer.
5. Repeat steps 1 to 4 for LCT paper feed.

Note: With the LCT, the paper is not inverted as it is when fed from the copier trays. Therefore, the same brand of paper should yield opposite results. Please confirm this when testing with the LCT and write in the brand name on the appropriate label.

6. Attach the two decals [A] to the copier paper feed tray and LCT as shown.

Note: Two decals can be attached to each copier feed tray. However, there is only room for one decal on the LCT. Therefore, attach the LCT decal with more brand names onto the LCT itself. Attach the other to one of the areas labeled [B] below, whichever the customer prefers.

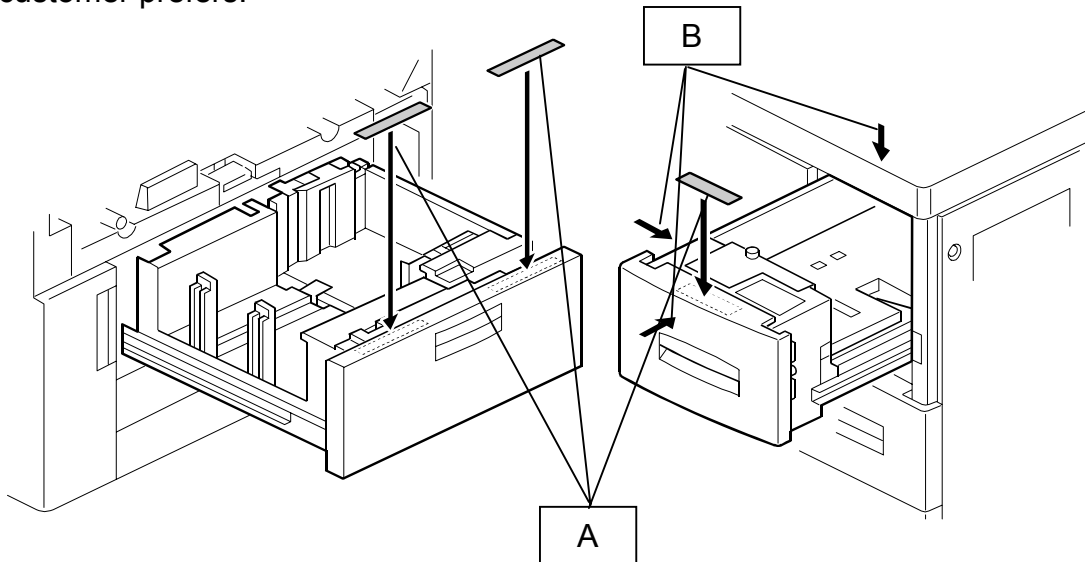

Example:

Copier feed:

Brand A curls less when facing up.

Brand B curls less when facing down.

LCT feed:

Brand A curls less when facing down.

Brand B curls less when facing up.

Model: Bellini

Date: 26-May-00

No.: RA294013

Copier feed:

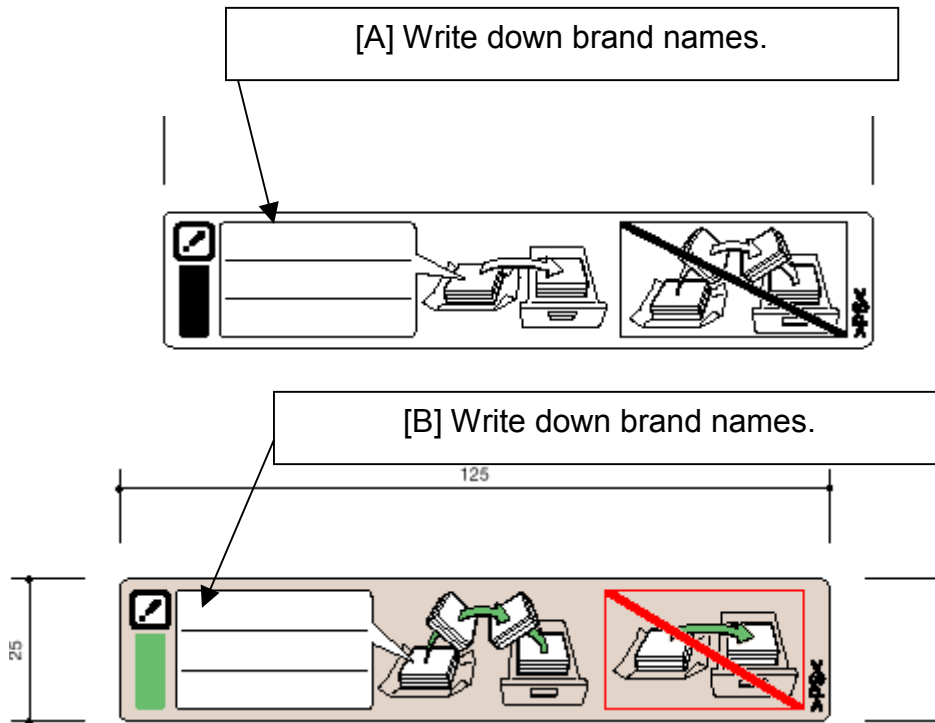

LCT feed:

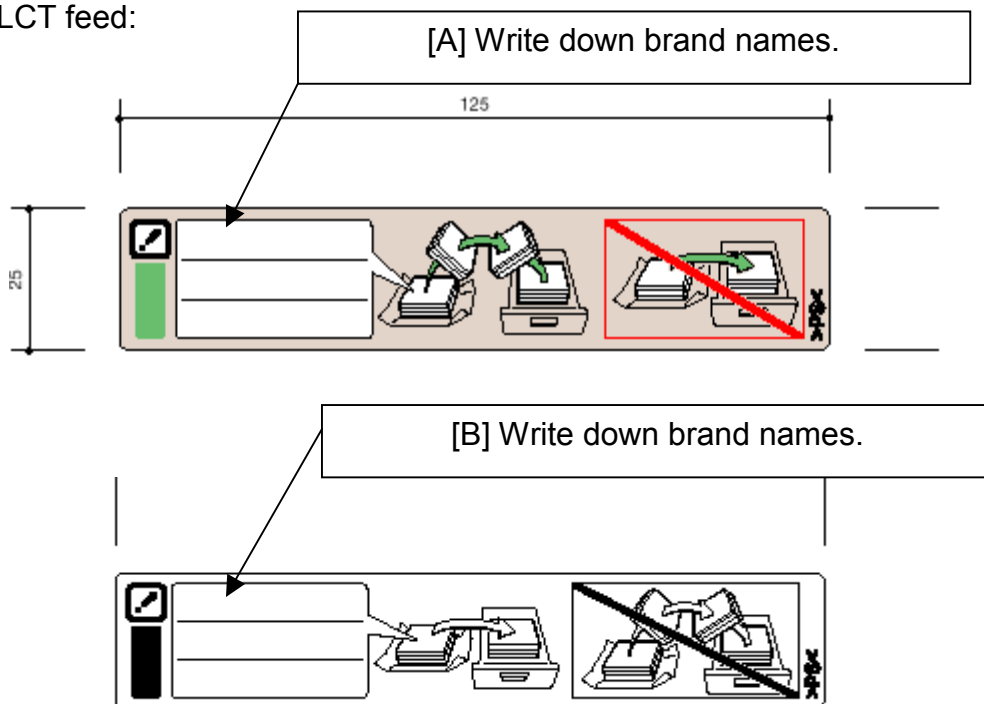

Model: Bellini		Date: 19-Jul-00	No.: RA294024
Subject: LCT Tray Heater Kit		Prepared by: H.K.	
From: Technical Services Dept., GTS Division			
Classification:	<input type="checkbox"/> Troubleshooting	<input checked="" type="checkbox"/> Part information	<input type="checkbox"/> Action required
	<input type="checkbox"/> Mechanical	<input type="checkbox"/> Electrical	<input type="checkbox"/> Service manual revision
	<input type="checkbox"/> Paper path	<input type="checkbox"/> Transmit/receive	<input type="checkbox"/> Retrofit information
	<input type="checkbox"/> Other ()		

Part Number of the Tray Heater Kit

The part number for the LCT Tray Heater Kit is not listed in the parts catalogue or service manual. This kit can be ordered as a spare part.

The part number is as follows:

Old part number	New part number	Description	Q'ty
	A2949500	Tray Heater Kit - 230V 18W	1

This kit includes the following components:

Old part number	New part number	Description	Q'ty
	AX400053	Anti-Condensation Heater - 240V 18W	2
	B3033841	Heater Cover	1
	B3035324	Interface Harness	1
	04514008B	Philips Tapping Screw - M4x8	6
	11050310	Harness Clamp - LWS-1S	2
	11050292	Wire Saddle	1

Model: Bellini

Date: 19-Jul-00

No.: RA294024

Installation procedure for the Tray Heater Kit

1. Remove the LCT unit from the main copier and remove the LCT right cover.
2. Attach the two anti-condensation heaters [A and B] (2 screws each) to the LCT bottom plate.
3. Attach the heater cover [C] (2 screws).
4. Attach the two cable clamps [D] to the LCT bottom plate as shown.
5. Lead the heater cables [E and F] through the cable clamps. Insert the connectors into the connector bracket holes shown below.
6. Connect the connectors [G and H] (interface cables) to the connectors that were just inserted into the connector bracket holes (step 5).

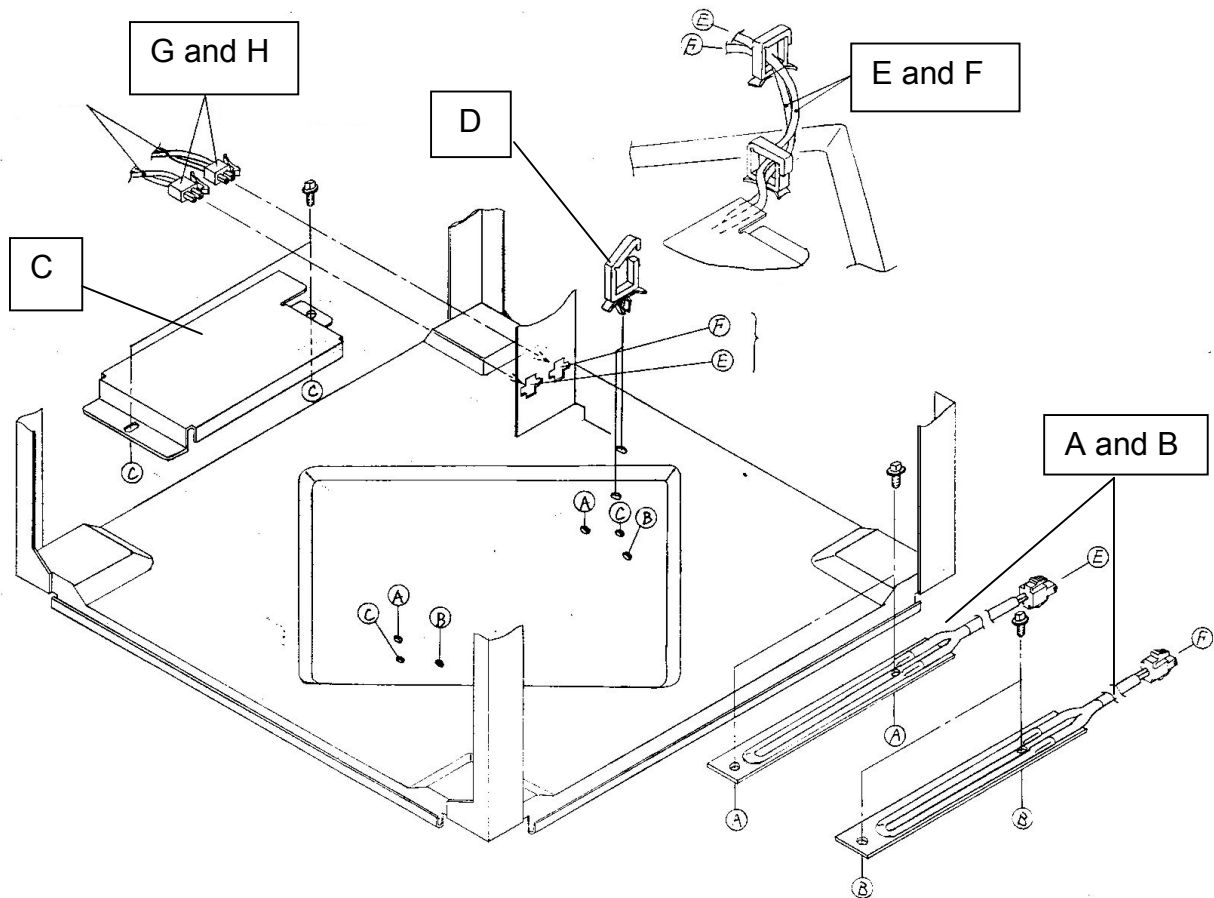

Model: Bellini

Date: 19-Jul-00

No.: RA294024

For steps 7-10, refer to the second illustration below.

Note: In accordance with safety standards, the connecting cable [A] must not be touching the interface cable [B] when the optional LCT tray heaters are installed. Therefore, be sure to perform steps 7-10 so that the cables remain separated.

7. Replace the wire saddle with the new one ([C] P/N: 11050292), which is included in the optional tray heater kit.
8. Lead the connecting cable [A] as shown.
9. Connect the connector [D] of the interface cable to the mainframe interface.
10. Re-install all parts.

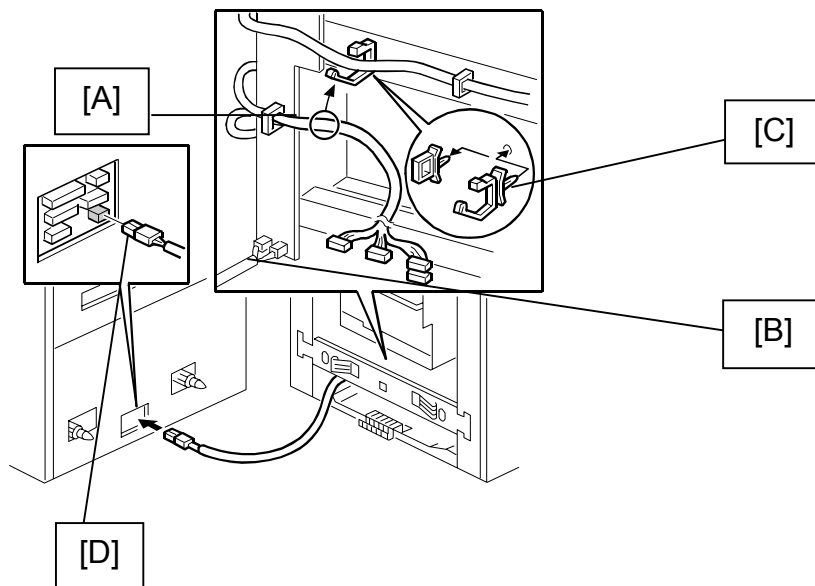

Model: Bellini

Date: 19-Jul-00

No.: RA294024

As mentioned on pg. 2-124 of the Service Manual, all anti-condensation heaters are disconnected from the AC drive board before being shipped.

When the heater AC cable connector [A] is connected to the AC drive board, the transfer anti-condensation (drum) heater will be turned on along with the other optional heaters when the main switch is off.

⚠ Caution: Before plugging in the heater AC harness connector, be sure to turn off the main switch and unplug the copier power cord.

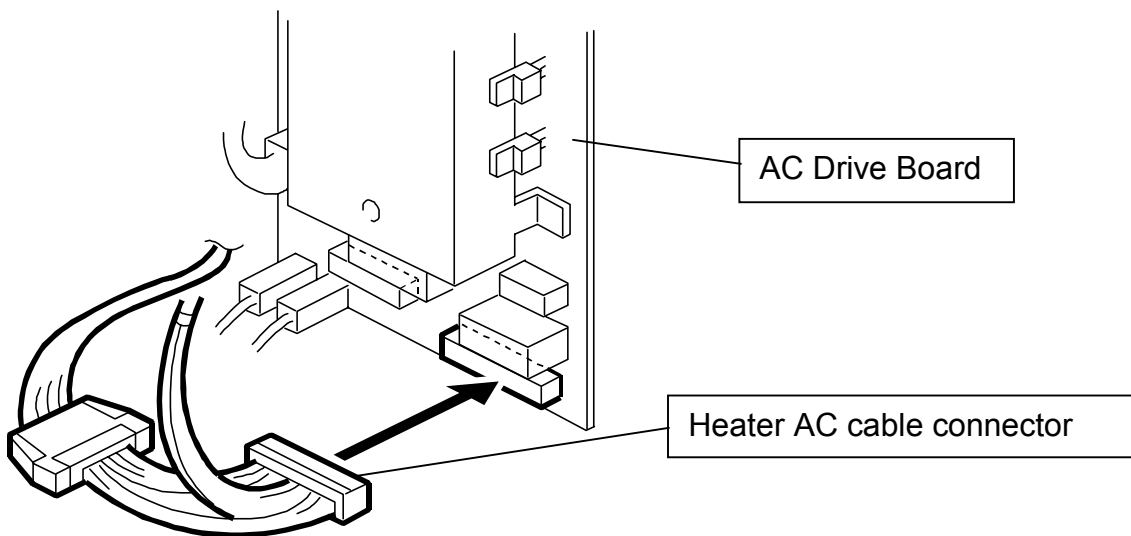

Note: The heater AC cable connector is hung on the clamp under the AC drive board.

Model: Bellini		Date: 13-Oct-00	No.: RA294035
Subject: Multi-feeding fom LCT		Prepared by: S. Hizen	
From: Technical Services Dept., GTS Division			
Classification:	<input checked="" type="checkbox"/> Troubleshooting	<input type="checkbox"/> Part information	<input type="checkbox"/> Action required
	<input type="checkbox"/> Mechanical	<input type="checkbox"/> Electrical	<input type="checkbox"/> Service manual revision
	<input type="checkbox"/> Paper path	<input type="checkbox"/> Transmit/receive	<input type="checkbox"/> Retrofit information
	<input type="checkbox"/> Other ()		

SYMPTOM

Multi-feeding from the LCT.

CAUSE

The paper stack height is too high.

SOLUTION

Lower the paper stack height by shifting the tray lift sensor.

The procedure is as follows:

1. Remove the LCT right cover and inner cover and pull out the tray.
2. Remove the paper feed unit (see the service manual, page 6-62).

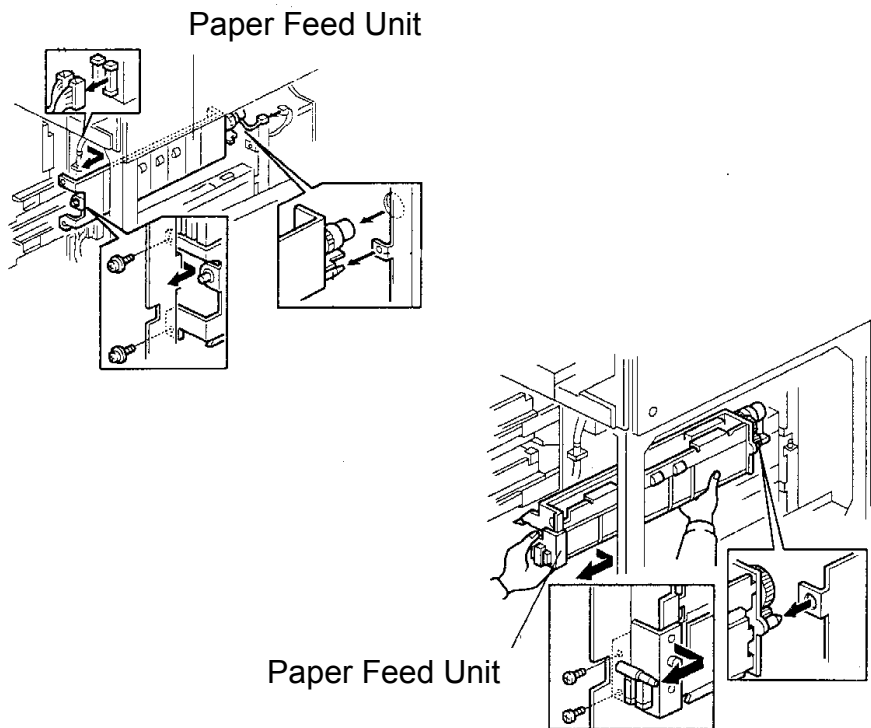

3. Remove the sensor bracket.
4. Remove the paper lift sensor.

Model: Bellini

Date: 13-Oct-00

No.: RA294035

5. Remove the cut-out from the bracket with a pair of wire cutters as shown in the illustration.
6. Install the paper lift sensor on the bracket.
7. Install the bracket as shown in the illustration. The gap between the bracket and the unit is 2.5 mm (0.1 inch): **If the customer uses thicker paper and non-feeding occurs, shift the sensor bracket to reduce the gap.**

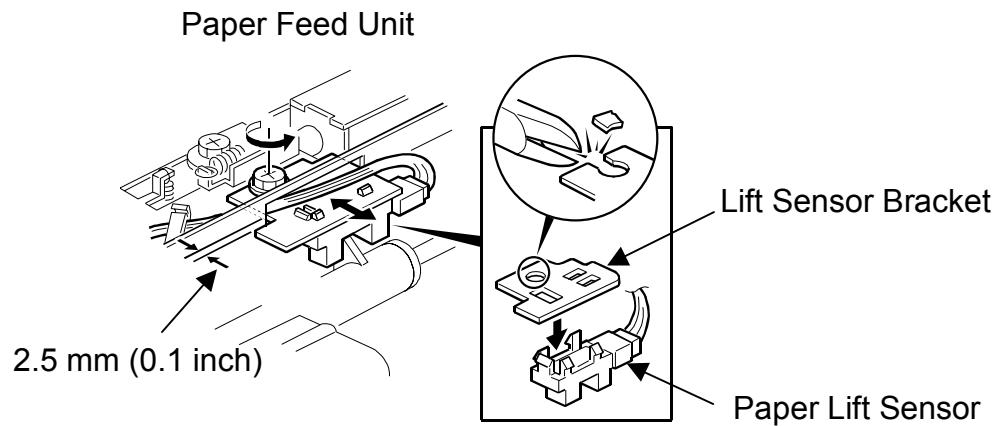

Model: Bellini		Date: 09-Nov-00	No.: RA294038
Subject: LCT Guide Plate Kit		Prepared by: J. Mochizuki	
From: Technical Services Dept., GTS Division			
Classification:	<input type="checkbox"/> Troubleshooting	<input type="checkbox"/> Part information	<input type="checkbox"/> Action required
	<input type="checkbox"/> Mechanical	<input type="checkbox"/> Electrical	<input type="checkbox"/> Service manual revision
	<input type="checkbox"/> Paper path	<input type="checkbox"/> Transmit/receive	<input checked="" type="checkbox"/> Retrofit information
	<input type="checkbox"/> Other ()		

To improve durability, the guide plate B3033645 and related parts have been modified. For details please refer to MB303007. A2949902 (LCT Guide Plate Kit) has been registered as a service part to supply the modified parts as a set.

This kit includes the following parts:

- [A] B3033646 Guide Plate (1 pc)
- [B] B3033680 Linkage Bracket (1 pc)
- [C] B3033685 Collar (1 pc)
- [D] AA060830 Tighten Spring (1 pc)
- [E] 68032273 Stepped Screw (1 pc)
- [F] B3031330 Decal - Misfeed

[A] to [E] of the above list have been used for mass production machines from the following cut-in serial numbers. Please refer to MB303007.

- B30314 L0680080001
- B30317 H3900700001
- B30324 L0680080029
- B30326 4B30800001
- B30327 H3900800146

B3031330 [F] includes three decals which will be stuck on the LCT inner cover from November production.

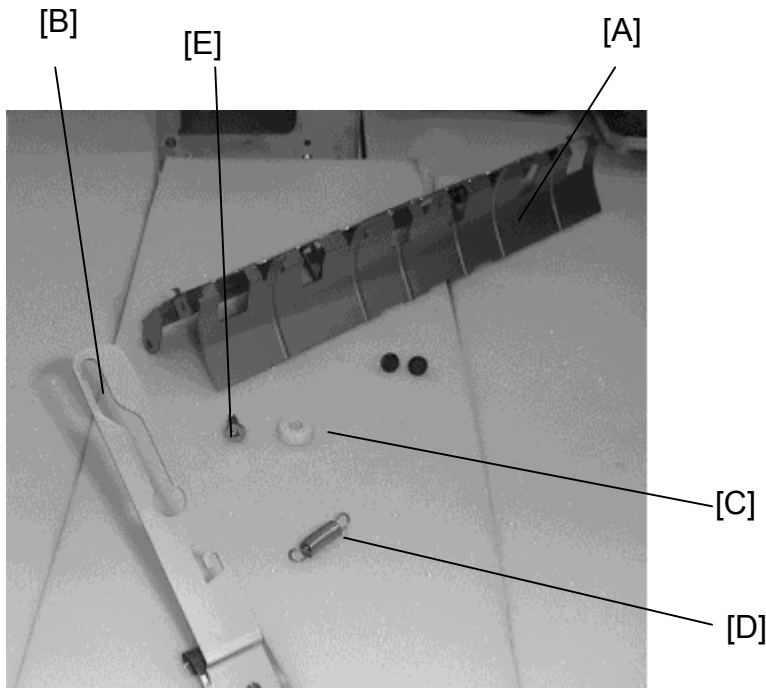

Model: Bellini

Date: 09-Nov-00

No.: RA294038

Guide plate installation procedure

1. Removal of Relay Transport Unit from LCT.

(1) Remove the stay from the LCT (4 screws).

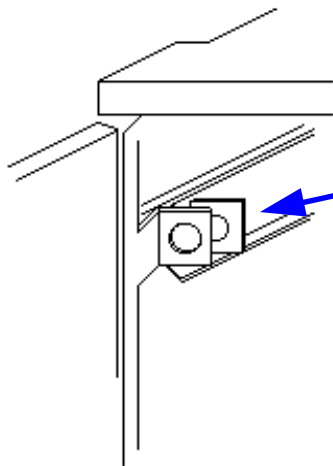
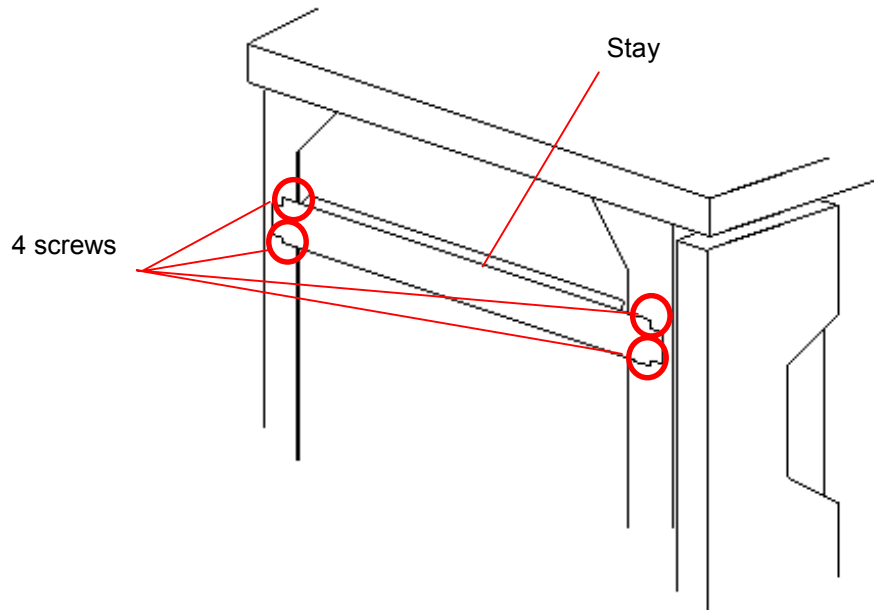

Note: When removing the stay, be careful not to deform the part shown in the illustration to the left.

Model: Bellini

Date: 09-Nov-00

No.: RA294038

(2) Remove the harness around the relay transport unit from the harness clamps and board.

[Front view of Relay Transport Unit]

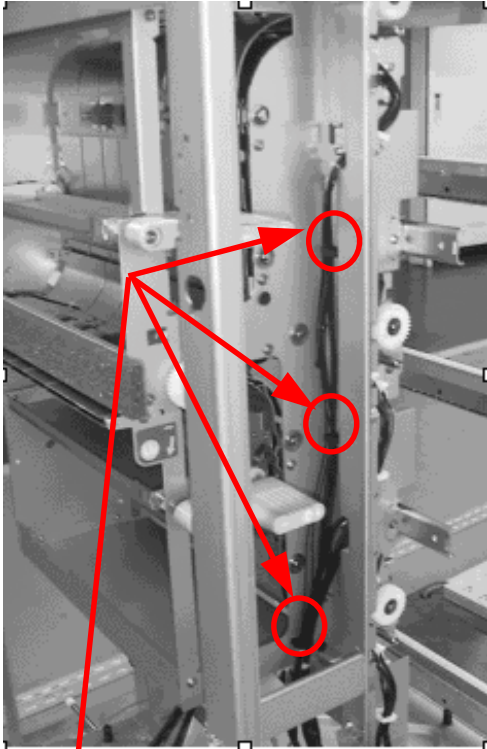

Remove harness from clamps.

[Rear view of Relay Transport Unit]

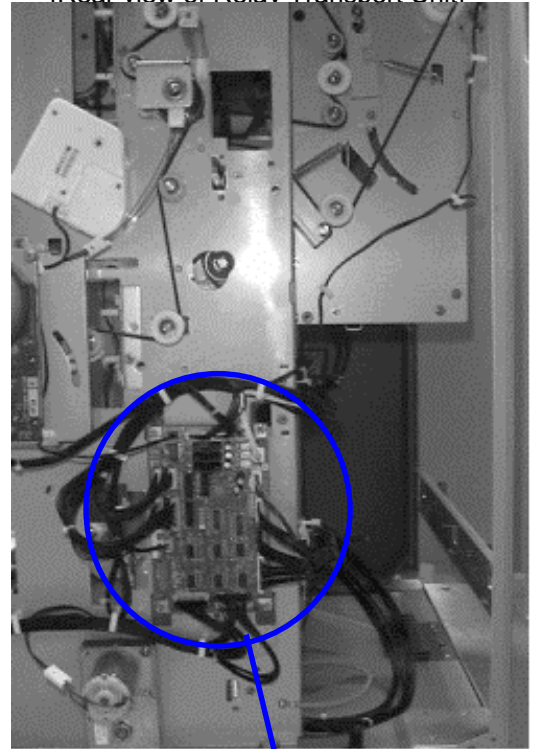

Remove the connector on the right.

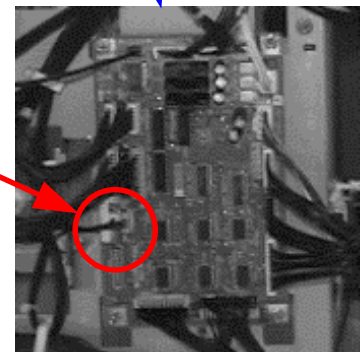

Model: Bellini

Date: 09-Nov-00

No.: RA294038

(3) Remove the relay transport unit from the LCT (4 screws).

Note: As there are hooks, please lift and remove the relay transport unit.

[Front view of Relay transport unit]

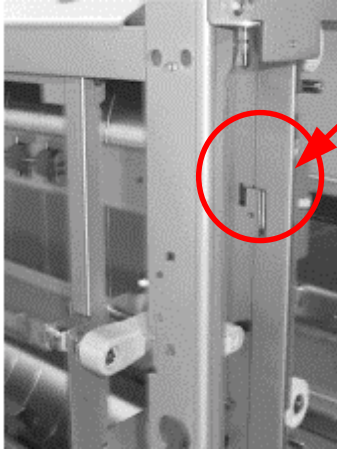

[Rear view of Relay transport unit]

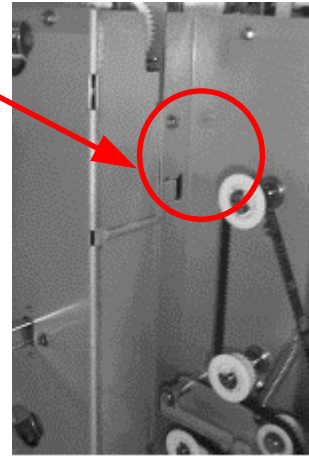

Caution: Please be careful when handling the relay transport unit because there are sharp edges on the unit.

2. Removal of Old Parts on the Relay Transport Unit

P. 4/7

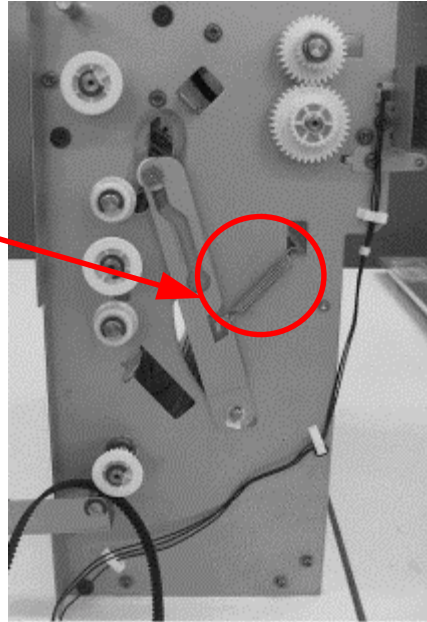
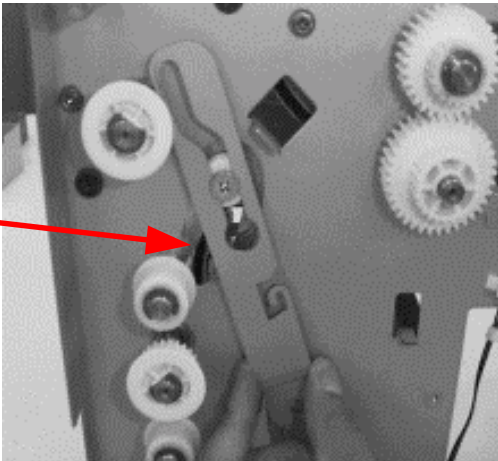
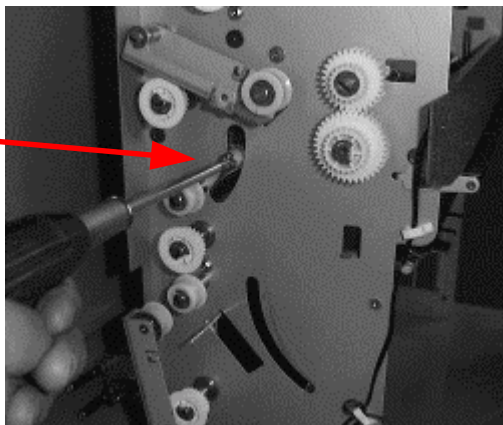
(1) Remove the spring.AA060817
Tighten Spring**(2) Remove the linkage bracket.**B3033681
Linkage Bracket**(3) Remove the Stepped Screw.**AA143444
Stepped Screw

Model: Bellini

Date: 09-Nov-00

No.: RA294038

(4) Remove the guide plate (2 stepped screws).
[Front view of Relay Transport Unit]

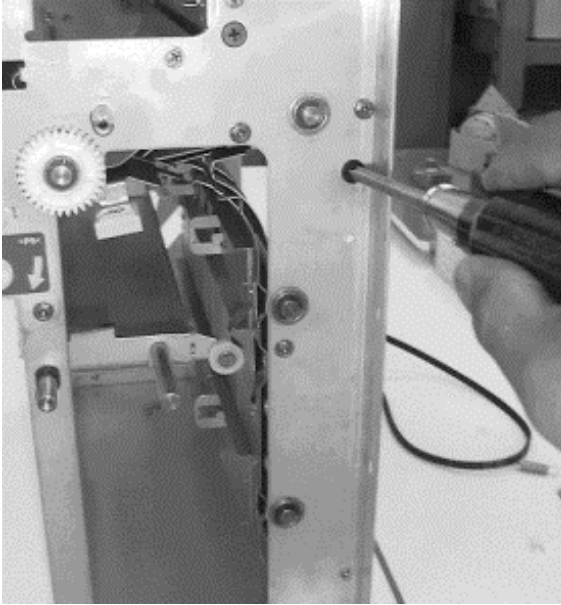

[Rear view of Relay Transport Unit]

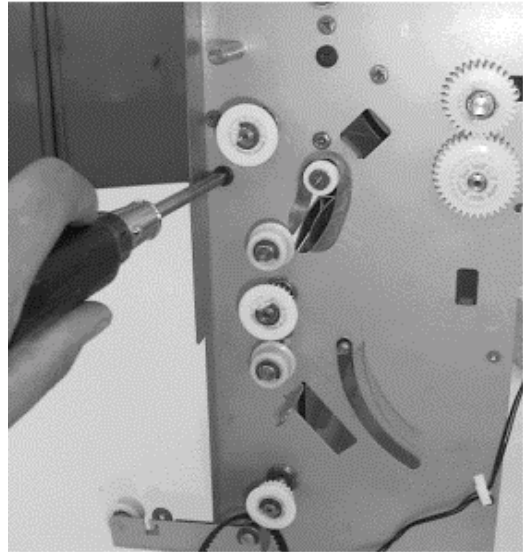

B3033645
Guide Plate

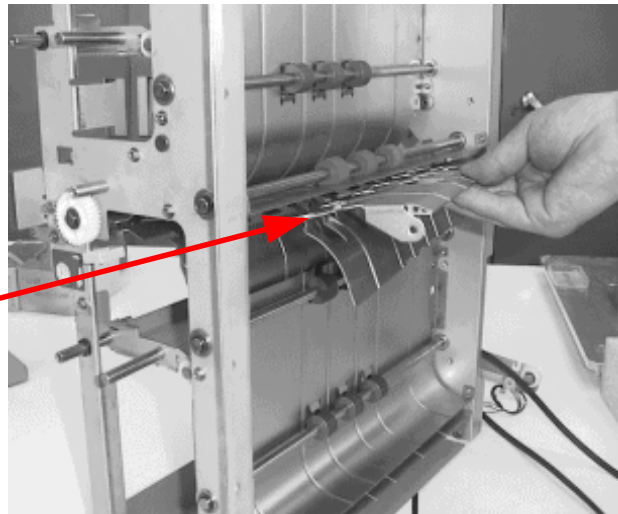

3. Installation of Countermeasure Parts on Relay Transport Unit

(1) Install the guide plate (B3033646) (2 stepped screws)

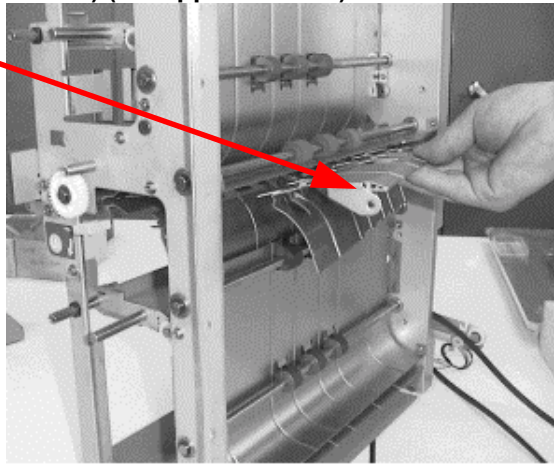

[Front view of Relay Transport Unit]

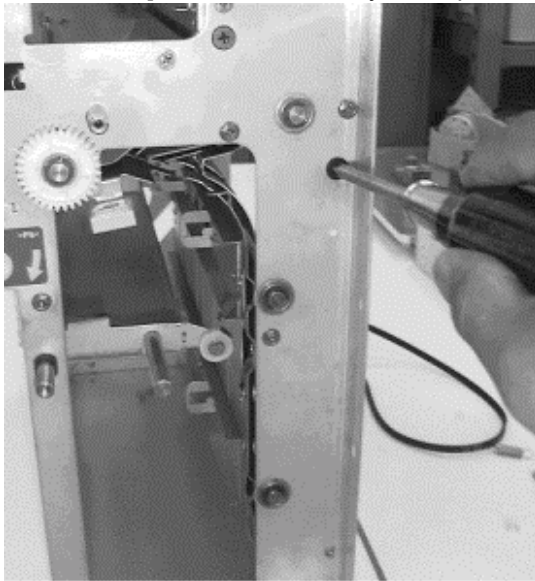

[Rear view of Relay Transport Unit]

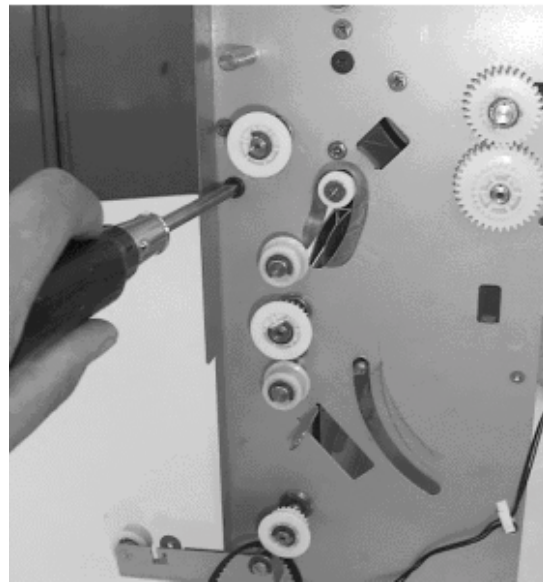

(2) Install the collar (B3033685) with the stepped screw (68032273)

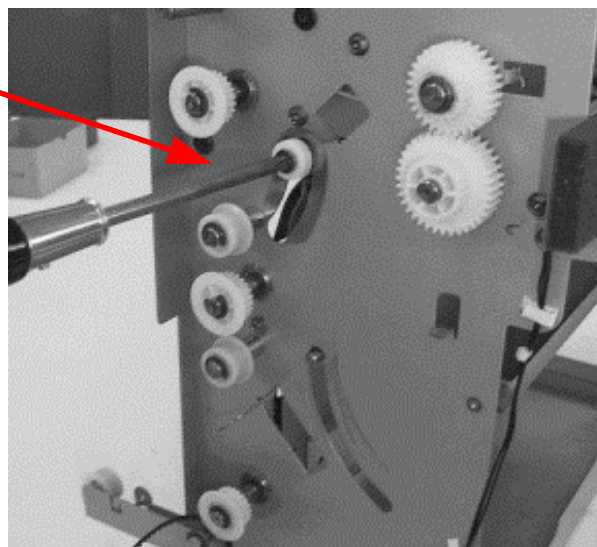

Model: Bellini

Date: 09-Nov-00

No.: RA294038

(3) Install the linkage bracket by hooking it on the stepped screw.

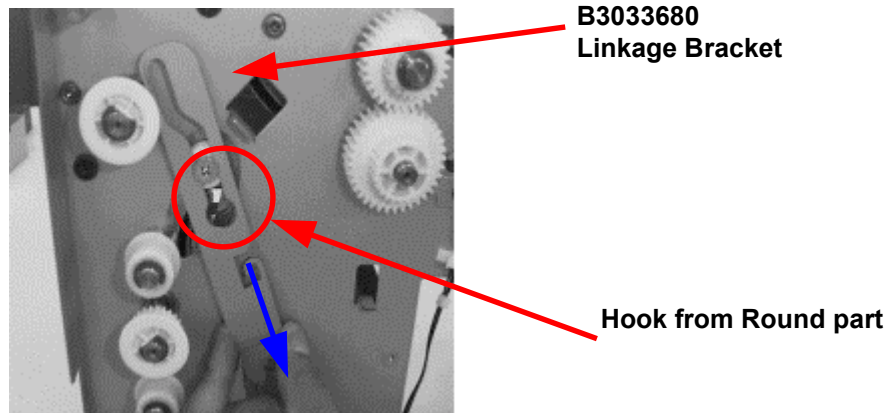

(4) Lubricate with Silicone Grease G501 (52039502) at the parts in the photo.

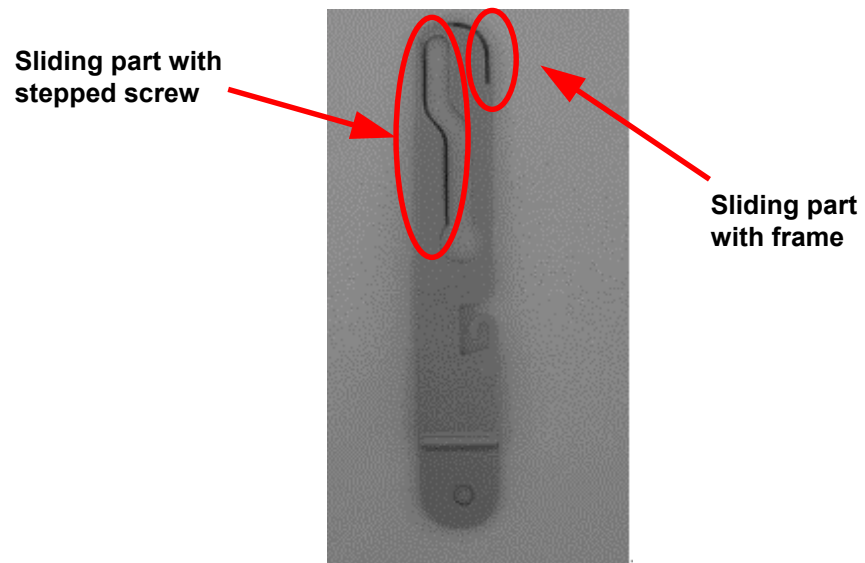

(5) Install the tighten spring (AA060380)

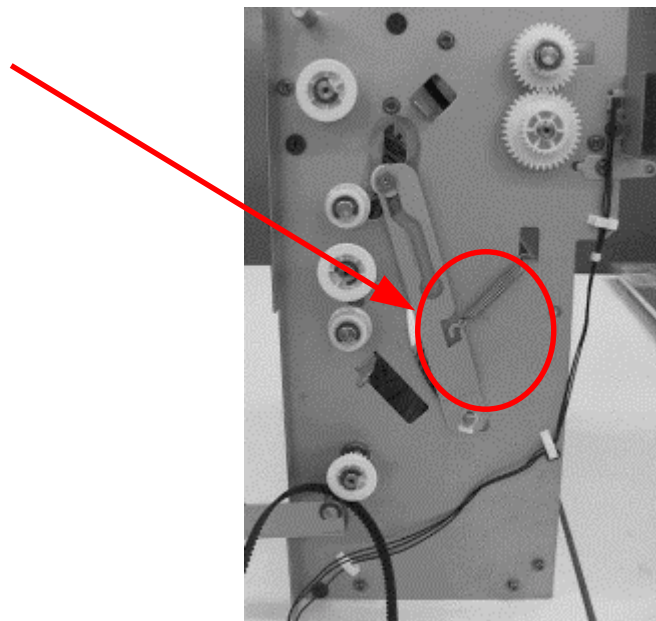

(6) Re-install the relay transport unit.

(7) Re-assemble the LCT.